



# Winnie the Pooh

## User's Manual

# Play & Learn Laptop

6-36  
Months



**vtech**<sup>®</sup>

© Disney Based on the "Winnie the Pooh"  
works by A.A. Milne and E.H. Shepard.

Visit the Disney website at [www.disney.com](http://www.disney.com)

© 2011 VTech Printed in China



Dear Parent,

Ever notice the look on your baby's face when they learn something new through their own discovery? These self-accomplished moments are a parent's greatest reward. To help fulfill them, **VTech**<sup>®</sup> created the **Infant Learning**<sup>®</sup> series of toys.

These unique interactive learning toys directly respond to what children do naturally – play! Using innovative technology, these toys react to baby's interactions, making each play experience fun and unique as they learn age-appropriate concepts like first words, numbers, shapes, colors and music. More importantly, **VTech**<sup>®</sup>'s **Infant Learning**<sup>®</sup> toys develop baby's mental and physical abilities by inspiring, engaging and teaching.

At **VTech**<sup>®</sup>, we know that a child has the ability to do great things. That's why all of our electronic learning products are uniquely designed to develop a child's mind and allow them to learn to the best of their ability. We thank you for trusting **VTech**<sup>®</sup> with the important job of helping your child learn and grow!

Sincerely,

Your friends at **VTech**<sup>®</sup>

To learn more about the **Infant Learning**<sup>®</sup> series and other **VTech**<sup>®</sup> toys, visit [www.vtechkids.com](http://www.vtechkids.com)

# INTRODUCTION

Thank you for purchasing the **VTech® Play & Learn Laptop!**

The **Play & Learn Laptop** is an interactive toy that will entertain your little one as they are introduced to shapes, colors, numbers and characters with their favorite friend Pooh. **Learning, Music** and **Follow the Lights** modes encourage learning through play while the manipulative features help your child develop important motor skills. Flashing lights, bright colors and fun sounds add to the enjoyment.

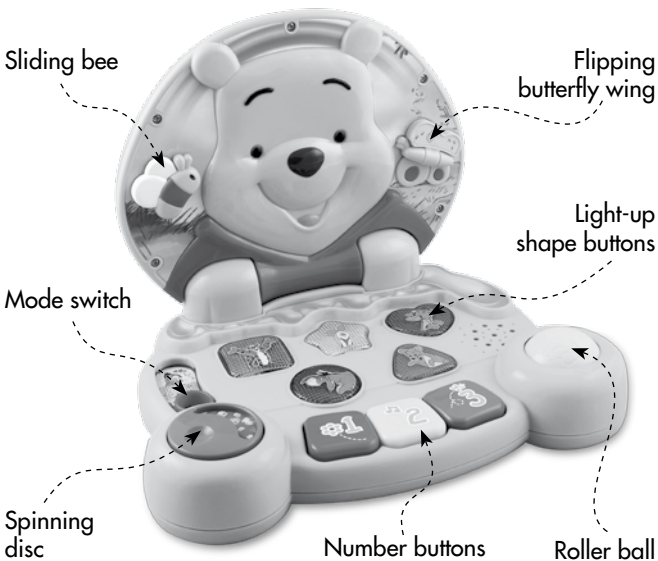

# INCLUDED IN THIS PACKAGE

- One VTech® Play & Learn Laptop
- One User's Manual

**WARNING:** All packing materials, such as tape, plastic sheets, packing locks, wire ties and tags are not part of this toy, and should be discarded for your child's safety.

**NOTE:** Please keep user's manual as it contains important information.

Unlock the packing locks:

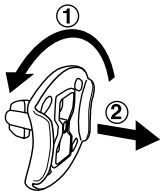

- ① Rotate the packing locks 90 degrees anti-clockwise.
- ② Pull out the packing locks.

## BATTERY INSTALLATION

1. Make sure the unit is turned **OFF**.
2. Locate the battery cover on the back of the unit. Use a coin or a screwdriver to loosen the screw.
3. Install 2 new 'AA' (AM-3/LR6) batteries following the diagram inside the battery box. (The use of new alkaline batteries is recommended for maximum performance.)
4. Replace the battery cover and tighten the screw to secure.

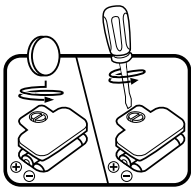

# BATTERY NOTICE

- The use of new alkaline batteries is recommended for maximum performance.
- Non-rechargeable batteries are not to be recharged.
- Rechargeable batteries are to be removed from the toy before being charged (if removable).
- Rechargeable batteries are only to be charged under adult supervision (if removable).
- Different types of batteries or new and used batteries are not to be mixed.
- Only batteries of the same or equivalent type as recommended are to be used.
- Batteries are to be inserted with the correct polarity.
- Exhausted batteries are to be removed from the toy.
- The supply terminals are not to be short-circuited.
- The toy is not to be connected to more than the recommended number of power supplies.
- Do not dispose of batteries in fire.

## **WE DO NOT RECOMMEND THE USE OF RECHARGEABLE BATTERIES.**

### NOTE:

Help the environment by disposing of your product responsibly.

The wheelie bin symbols indicate the product and batteries must not be disposed of in the domestic waste as they contain substances which can be damaging to the environment and health. Please use designated collection points or recycling facilities when disposing of the item or batteries.



More information can be found on:

<http://www.recycle-more.co.uk>; [www.recyclenow.com](http://www.recyclenow.com)



# PRODUCT FEATURES

## 1. LEARNING/ MUSIC/ FOLLOW THE LIGHTS/ OFF MODE SWITCH

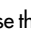
To turn the unit **ON**, slide the **LEARNING / MUSIC / FOLLOW THE LIGHTS / OFF MODE SWITCH** to the **Learning Mode** (  ), the **Music Mode** (  ) or the **Follow the Lights Mode** (  ) position. To turn the unit **OFF**, slide the **LEARNING / MUSIC / FOLLOW THE LIGHTS / OFF MODE SWITCH** to the **OFF** (  ) position or close the laptop lid. If a mode is selected you can open the laptop lid to turn the unit **ON**.



## 2. AUTOMATIC SHUT-OFF

To preserve battery life, the **VTech® Play & Learn Laptop** will automatically power-down after approximately **30** seconds without input. The unit can be turned on again by pressing any button.

# ACTIVITIES

1. Slide the **LEARNING/ MUSIC / FOLLOW THE LIGHTS / OFF MODE SWITCH** or, if a mode is selected just open the lid, to turn the unit **ON**. You will hear a fun song and phrase in **Learning Mode** and **Music Mode**. In the **Follow the Lights Mode** you will hear piano notes and an encouraging phrase to start the game. The lights will flash with the sounds.



2. Press the **SHAPE BUTTONS** in **Learning Mode** to hear fun sounds and the shapes and characters identified. In **Music Mode** you will hear fun sounds and melodies. Press these



buttons as they light up in **Follow the Lights Mode** to play the game. The lights will flash with the sounds.

3. Press the **NUMBER BUTTONS** in **Learning Mode** to hear colors, numbers, short tunes and piano notes. In **Music Mode** and **Follow the Lights Mode** you will hear piano notes. The lights will flash with the sounds.



4. Flip the **BUTTERFLY WING** in **Learning Mode** to hear a fun sound and phrase. In **Music Mode** you will hear a fun sound and melody. In **Follow the Lights Mode** you will hear a fun sound. The lights will flash with the sounds.



5. Turn the **SPINNING DISC** in **Learning Mode** to hear a fun sound and an encouraging phrase to find a character. In **Music Mode** you will hear a fun sound and melody. In **Follow the Lights Mode** you will hear a fun sound and phrase. The lights will flash with the sounds.



6. Roll the **ROLLER BALL** to hear short tunes played note by note as you are rolling. In **Learning Mode** and **Follow the Lights Mode**, a short upward roll will identify 'up' and a short downward roll will identify 'down' followed by a short tune. The lights will flash with the sounds.



7. Move the **SLIDING BEE** in **Learning Mode** to hear a fun sound, phrases and songs. In **Music Mode** you will hear a fun song, sound and melody. In **Follow the Lights Mode** you will hear a fun sound and song. The lights will flash with the sounds.

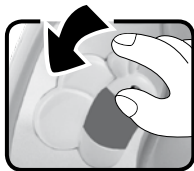

8. Close the laptop lid to hear a closing short tune and a phrase before the unit turns **OFF**.
9. When a melody is playing, press the **SHAPE BUTTONS**, move the **SLIDING BEE** or flip the **BUTTERFLY WING** to add sounds to the music. Press the **NUMBER BUTTONS** to play the melody one note at a time. Roll the **ROLLER BALL** or turn the **SPINNING DISC** to increase the tempo of the melody.

## CARE & MAINTENANCE

1. Keep the unit clean by wiping it with a slightly damp cloth.
2. Keep the unit out of direct sunlight and away from any direct heat source.
3. Remove the batteries when the unit will not be in use for an extended period of time.
4. Do not drop the unit on hard surfaces and do not expose the unit to moisture or water.



# TROUBLESHOOTING

If for some reason the program/activity stops working or malfunctions, please follow these steps:

1. Please turn the unit OFF.
2. Interrupt the power supply by removing the batteries.
3. Let the unit stand for a few minutes, then replace the batteries.
4. Turn the unit ON. The unit should now be ready to play again.
5. If the product still does not work, replace with an entire set of new batteries.

If the problem persists, please call our Consumer Services Department at 1-800-521-2010 in the U.S. or 1-877-352-8697 in Canada, and a service representative will be happy to help you.

## IMPORTANT NOTE:

Creating and developing **Infant Learning** products is accompanied by a responsibility that we at **VTech®** take very seriously. We make every effort to ensure the accuracy of the information, which forms the value of our products. However, errors sometimes can occur. It is important for you to know that we stand behind our products and encourage you to call our Consumer Services Department at 1-800-521-2010 in the U.S., or 1-877-352-8697 in Canada, with any problems and/or suggestions that you might have. A service representative will be happy to help you.

## Note:

This equipment has been tested and found to comply with the limits for a Class B digital device, pursuant to Part 15 of the FCC Rules. These limits are designed to provide reasonable protection against harmful interference in a residential installation. This equipment generates, uses and can radiate radio frequency energy and, if not installed and used in accordance with the instructions, may cause harmful interference to radio communications. However, there is no guarantee that interference will not occur in a particular installation. If this equipment does cause harmful interference to radio or television reception, which can be determined by turning the equipment off and on, the user is encouraged to try to correct the interference by one or more of the following measures:

- Reorient or relocate the receiving antenna
- Increase the separation between the equipment and receiver
- Connect the equipment into an outlet on a circuit different from that to which the receiver is connected
- Consult the dealer or an experienced radio/TV technician for help

THIS DEVICE COMPLIES WITH PART 15 OF THE FCC RULES. OPERATION IS SUBJECT TO THE FOLLOWING TWO CONDITIONS: (1) THIS DEVICE MAY NOT CAUSE HARMFUL INTERFERENCE, AND (2) THIS DEVICE MUST ACCEPT ANY INTERFERENCE RECEIVED, INCLUDING INTERFERENCE THAT MAY CAUSE UNDESIRABLE OPERATION.

THIS CLASS B DIGITAL APPARATUS COMPLIES WITH CANADIAN ICES-003.

CET APPAREIL NUMÉRIQUE DE LA CLASSE B EST CONFORME À LA NORME NMB-003 DU CANADA.

Caution: Changes or modifications not expressly approved by the party responsible for compliance could void the user's authority to operate the equipment.

